

3. The airflow can be adjusted upward or downward by loosening the tilt adjustment knob and adjusted the vertical angle as desired. Retighten the knob securely.
4. The height of the fan can be adjusted by loosening the height adjustment ring carefully raising or lowering the fan and firmly tightening the ring.

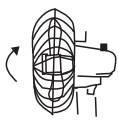

MAINTENANCE INSTRUCTION

- The fan requires little maintenance. Do not try to fix it by yourself. Refer it to qualified service personnel if service is needed.
1. Before cleaning and assembling, do not plug the pins into the socket.
 2. To ensure adequate air circulation to the motor. Keep vents at the rear of the motor housing from dust, fluff and etc. A vancuum cleaner can not be used to clean these vents before unplug. Do not disassemble the fan remove fluff.
 3. Please wipe the exterior parts with a soft cloth soaking a mild detergent. Do not use any abrasive detergent or solvents to avoid scratching the suface. Do not use of the following as a cleaner: gasoline, thinner, bending.
 4. Do not allow water or any other liquid into the motor housing or interior parts.

CLEANING

1. Be sure to unplug from the electrical supply source before cleaning.
2. Plastic parts should be cleaned with a soft cloth moisten with mild soap. Thoroughly remove soap film with dry cloth.

DISPOSAL: Do not dispose of electrical appliances as unsorted municipal waste, use separate collection facilities. Contact you local government for information regarding the collection systems available. If electrical appliances are disposed of in landfills or dumps, hazardous substances can leak into the groundwater and get into the food chain, damaging your health and well-being.



CAUTION

Read Rules for Safe Operation and Instructions Carefully.

WARNING

1. Do not leave the fan running unattended.
2. Keep electrical appliances out of reach from Children or infirm persons. Do not let them use the appliances without supervision.
3. Ensure that the fan is switched off from the supply mains before removing the guard.

4. If the supply cord is damaged, it must be replaced by manufacturer or its service agent or a similarly qualified person in order to avoid a hazard.
5. This appliance is not intended for use by persons (including children) with reduced physical, sensory or mental capabilities, or lack of experience and knowledge, unless they have been given supervision or instruction concerning use of the appliance by a person responsible for their safety.
6. Children should be supervised to ensure that they do not play with the appliance.

RULES FOR SAFE OPERATION

1. Never insert fingers, pencils, or any other object through the grille when fan is running.
2. Disconnect fan when moving from one location to another.
3. Disconnect fan when removing grilles for cleaning.
4. Be sure fan is on a stable surface when operating to avoid overturning.
5. DO NOT use fan in window, rain may create electrical hazard.
6. Indoor use only.

PART FIGURE

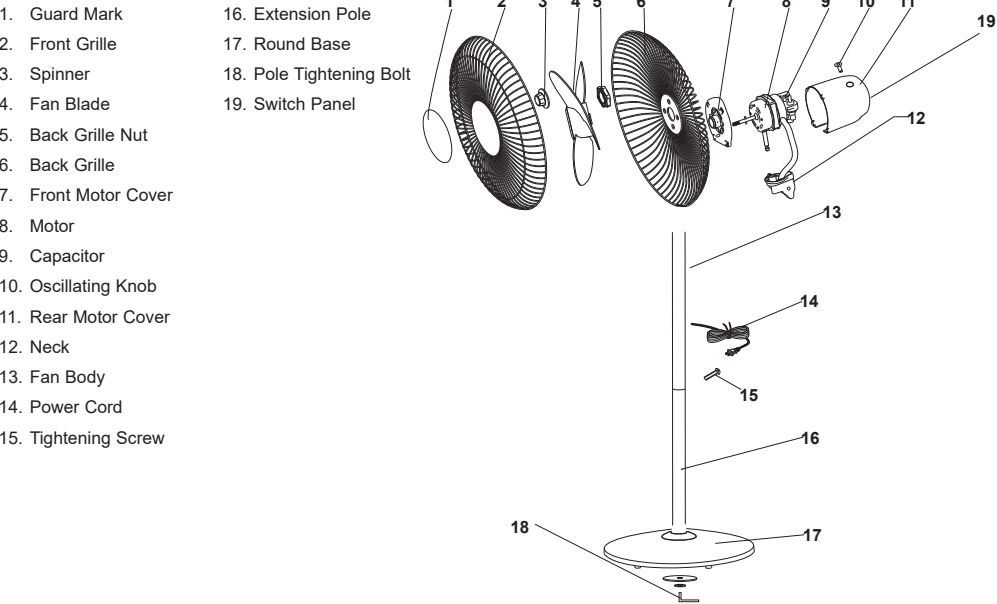

“Honor your father and mother so that you may live long
In the land the lord your God is giving you”
Exodus 20:12

Cherenz Global Mfg., Inc., distributor of Tough Mama Home and Kitchen Appliances, shall not be responsible for any fire, scalding or injury from misuse or negligence from the use thereof.

TOUGH MAMA®



INSTRUCTION MANUAL
SIMPLY 2-IN-1 FAN
MODEL.:NTM16-5XMO
READ AND SAVE THESE INSTRUCTIONS

ASSEMBLY OF BASE

1. Attach column to base with 4 screws as shown.
2. Unscrew / take out extension neck
3. Slides stand ornament down the column to rest on base.
4. Pull out the internal pole and screw / fasten the extension neck back.

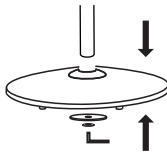

CAUTION: Height adjustment ring must be fully fastened before the assembly of the motor section to the stand.

ASSEMBLY OF BLADE OF GRILLES

1. Remove the spinner on the head unit by turning it clockwise. Then remove the plastic nut by turning it counterclockwise.
2. Place the rear guard to the head unit make sure the handle is upward.
3. Screw on the plastic nut (clockwise) securing the fan guard on the the head unit.
4. Discard the small plastic sleeve located on the motor shaft.
5. Install the fan blade onto the motor shaft. Make sure the fan blade slot fits into the retaining pin of the motor shaft.
6. Attach the spinner to the motor shaft by turning it counterclockwise to secure the fan blade.
7. Secure both guards firmly by tightening the fan guard then close easy clips.

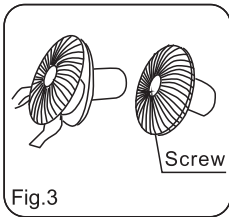
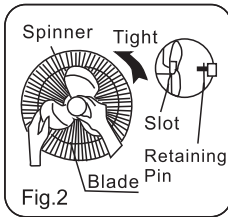
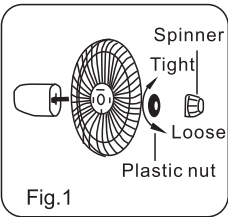

1. Speed is controlled by depressing the piano keys.
0---Stop 1---Lower 2---Medium 3---High

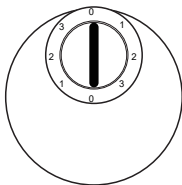

2. To make/stop the fan head oscillate. Push down/pull up the clutch knob.

