

TOUGH MAMA®

INSTRUCTION MANUAL

Commercial Blender

MODEL: NCB-3200



230V a.c. 60Hz 3200W

Please read all instructions before using this product.

Safety Instructions

- Remove all packaging material before using your TOUGH MAMA Blender for the first time. Wash the Jar, Blades, Tamper and Lid/Cover before first use, in warm soapy water. Wipe the Motor Base with a damp cloth.
- Do not place your TOUGH MAMA Blender near the edge of a bench or table during operation. Ensure the surface is stable, free of liquids or other substances.
- Do not place your TOUGH MAMA Blender on or near a hot stove or oven.
- Do not put the Motor Base of the Blender in water or any other liquids.
- Unplug Blender from outlet when not in use, before putting on or taking off parts, and before cleaning or removing contents from the jar. Do not put hands into the Jar. Do not touch the blades when the appliance is plugged in.
- Not recommended for microwave use.
- Do not place utensils into the jar while blending.
- Never operate damaged appliance (incl. Main cable).
- Operate appliance only through a professionally installed socket supplying the correct voltage and do not use extension cables.
- Never remove main cable with wet hands, or place cable on hot surface, or let cable come into contact with oil.
- Always operate the jar's attachment with the Lid in place.
- Do not try and perform any maintenance other than cleaning.
- Never leave your Blender unattended while in operation.
- Do not operate outdoors.
- This appliance is not intended for use by young children or infirm persons without supervision.
- Use a fire blanket only to extinguish fires on appliance.
- Never immerse the appliance in the water or other liquids to avoid damage and danger.
- If the supply cord is damaged, it must be replaced by the manufacturer, its service agent or similarly qualified persons in order to avoid any hazard.

Know your TOUGH MAMA Blender

Lid:

Push the Lid firmly into the Jar until both side clips are securely in position.

WARNING: Do not operate the Blender without the Lid.

Filler Cap:

Insert Filler Cap into the Lid.

2L Blender Jar:

To start blending, place the Jar on the Centring Pad, ensuring that it is fully in position.

The 2L Jar is made from almost unbreakable, BPA free, Triton plastic.

Blade Assembly:

The TOUGH MAMA Blender features a unique 8 blade stainless steel assembly, which is designed to break up tough seeds, thick vegetable stems and tough fruit skin, releasing the hidden nutrition inside.

Locking Nut:

Fastens the Blade Assembly to the Jar.

Drive Socket:

Made from hardened metal. The Drive Socket connects the Blade Assembly to the Motor Base, activating the blades.

Know your TOUGH MAMA Blender

Variable Speed Control:

The Variable Speed dial is used to select blade rotation speeds. To increase the speed, turn clockwise; to decrease the speed, turn counter-clockwise.

Centring Pad:

Place the Jar on the Centring Pad when it's ready to operate.

Power Switch ON/OFF:

To turn the blender on and off. Always start the machine with the Variable Speed Control pointed to LOW.

Pulse Control:

Allows short controlled bursts of operation. Press down and hold to operate. To stop operation, release the switch.

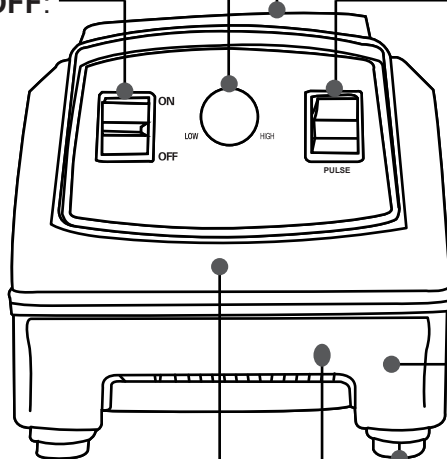

Motor Base:

Contains the control panel plus the heavy duty 3200W motor featuring overload protection.

Power Cord

Rubber Feet:

Four anti-slip feet.

Automatic Overload Protection:

The overload protector will trip if the motor overheats. If this occurs, allow the motor to cool down with power off for up to 45 minutes.

Know your TOUGH MAMA Blender

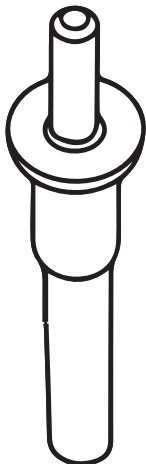

Tamper:

The Tamper allows you to accelerate the process of blending very thick and/or frozen mixtures that cannot be processed in a regular blender. Use it to help safely loosen up blocked ingredients so the circulation is maintained during blending.

Remove the Filler Cap and insert the Tamper up to the stopper. Hold the Jar's handle with one hand and move the Tamper in a circular motion, and up and down to unblock the contents of the Jar.

Warning: Only use the Tamper when the Lid is clipped into position and the ingredients have stopped circulating.

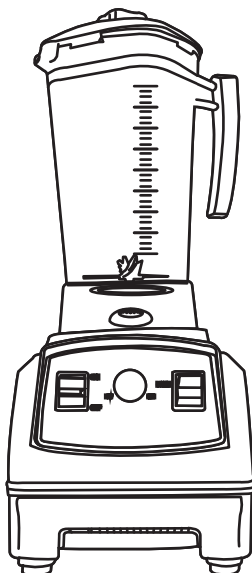

Know your TOUGH MAMA Blender

End results are uneven - Reduce the amount of ingredients in the Jar.
Ensure all ingredients are cut approximately the same size.

Ingredients are too fine - Use the Pulse function to prevent over processing.

Liquid is spilling out the Jar - Reduce the amount of ingredients in the Jar and make sure the Lid and Filling Cap are securely in place.

Automatic Overload Protection:

The Automatic Overload Protection feature is designed to protect the motor and prevent the blender from overheating. If the Automatic Overload Protection is activated it will cause the motor to shut off and possibly emit a light odour. If your Automatic Overload Protection should ever be activated, turn off the power switch and rest for up to 45 minutes in a cool place.

Locking Nut:

In the event that the locking nut at the bottom of your Jar loosens and no longer securely holds the blade assembly in place, DO NOT CONTINUE TO USE THE BLENDER.

Using your TOUGH MAMA Blender

Before Using Your TOUGH MAMA Blender:

Remove all packaging material before using your TOUGH MAMA Blender for the first time. Wash the Jar, Blades, Tamper and Lid/Cover before first use in warm soapy water. Wipe the Blender Base with a damp cloth.

General:

1. Place the Blender on a level surface, indoors.

WARNING: Do not operate the Blender when the Jar is empty.

2. Add the ingredients to the Jar and clip the Lid securely into place. Then position Jar on to the Centring Pad. Once in place, put the Filler Cap in its position by pushing it down firmly into the Lid. Always use both the Lid and the Filler Cap when blending, unless the tamper is inserted through the Filler Cap opening. It is important that when blending hot ingredients, make sure the lid is closed.

TIP: Place liquids and soft foods in the Jar first, followed by solid items and then ice.

3. Set the Variable Speed Control to LOW and turn on the Blender. Slowly increase speed dial as required. Let the Blender run until the desired consistency has been reached.
4. Due to the TOUGH MAMA Blender power and speed, processing times are much quicker than standard appliances. Until you are fully familiar with the machine, watch the processing time carefully to avoid over processing.
5. When blending has been completed, switch the Power Switch to the OFF position. Unplug power cable from the wall socket and remove the Jar.

Using your TOUGH MAMA Blender

Tips for Using the Tamper:

- The Jar should not be more than two-thirds full when the Tamper is used during blending.
- To avoid overheating during blending, DO NOT use the Tamper for more than 30 consecutive seconds.
- If the ingredients are not circulating, the machine may have trapped an air bubble. Carefully remove the Filler Cap while making sure the lid stays firmly in place. Release the air bubble by inserting the Tamper through the Filler Cap opening. Hold the Jar's handle during this process to secure the Jar. If required, move the Tamper in a circular motion, and up and down to unblock the ingredients in the Jar.

WARNING: Do not try to force the Tamper deeper into the container.

Safety Tips:

WARNING: Do not attempt to remove the Jar from the Centring Pad while the motor is in operation.

WARNING: Do not operate the Blender Base without the Jar properly in position.

WARNING: If the ingredients stop circulating, DO NOT shake or move the Jar while the motor is running.

WARNING: Spinning blades can cause injury. Wait until the blades have completely stopped rotating before removing the Jar. NEVER reach into the Jar while it is placed on the Centring Pad.

WARNING: The Drive Socket, Locking Nut and Blades may become very hot after extended use. DO NOT touch. Allow to cool down before touching or cleaning.

Using your TOUGH MAMA Blender

Speed Setting Tips:

To minimize splatter, always start with the Variable Speed Control on the LOW setting, do not begin on HIGH setting.

With the Variable Speed Control set on LOW, turn the Blender on with the Power Switch. If a higher speed is required at this stage, slowly turn the Variable Speed Control dial to the desired speed depending on the recipe being made.

The HIGH speed setting can be used for most ingredients like fruit and vegetable juices, soups, shakes, smoothies, frozen mixtures, purées, nut butters and for grinding grains. Processing times will generally be less than one minute and some recipes will take less than 30 seconds. The HIGH speed setting provides the best results when breaking down ice, frozen fruit, whole fruits and vegetables, and grains to a smooth lump-free consistency.

TIP: Blending too long at too low a speed setting will overheat the machine and cause the Automatic Overload Protection to turn the machine off. Use the HIGH speed as often as possible to achieve the most uniform consistency. Blending on HIGH speed also maximizes the motor's cooling fan to avoid overheating. If the ingredients do not circulate on the HIGH setting, the machine may be overloaded or may have trapped an air bubble. Carefully remove the Filler Cap while making sure the lid stays firmly in place. Release the air bubble by inserting the Tamper through the Filler Cap opening. If circulation problems continue, reduce the machine speed. A lower speed may allow food to circulate when a higher speed does not. Once the food is circulating freely, increase the speed back to HIGH and continue processing.

Tips For Blending Ice:

To blend ice, place the ice cubes into the Jar. Attach the Lid and Filler Cap and place on the Centring Pad. Press and release the Pulse Switch, repeat until the desired consistency is reached. Add a little water and flavouring through the Filler Cap opening for a slushier consistency.

Using your TOUGH MAMA Blender

Tips for blending Dry Ingredients:

Follow general instructions when grinding dry ingredients.

Do not operate the blender for more than 90 seconds when processing dry ingredients. Grinding dry ingredients for more than two minutes could damage your blender:

The Pulse function comes in handy when processing dry ingredients. Use the Pulse switch for more accurate control of consistency.

When blending dry items, always be sure to add enough to cover the blades completely.

Regular blending of dry ingredients may result in cosmetic marring of the blender jar and cause the blades to become dull over time.

Grinding some herbs may release oils, causing the container to discolour permanently. Others have strong odours that may linger in the container, affecting the flavour of other foods. The grinding of some herbs and spices may also cause the blade to dull over time.

Tips for Blending Hot Liquids:

Always start blending on LOW speed with Hot Liquids to avoid splashing and possible burns.

Escaping steam, splashes or contents may scald. To secure the contents, lock the Lid and Filler Cap securely in place prior to operating the Blender.

Always allow hot liquids to stand for a few moments to permit steam to escape before processing.

WARNING: Never remove the Lid or Filler Cap or add ingredients while the hot contents are being processed.

When the processing of the hot liquids has been completed, remove the Filler Cap carefully to allow excess steam to escape.

Cleaning The TOUGH MAMA Blender

Jar Cleaning:

Fill the Jar half full with warm water and add a couple drops of dishwashing liquid then place the Lid and Filler Cap into position.

Turn the Blender on with the Variable Speed Control on LOW. Slowly increase the speed to HIGH. Run the Blender on HIGH speed for 30 to 60 seconds.

Turn off the blender and rinse the Jar under running water.

Tamper, Lid and Filler Cap

Separate each of these parts, and then wash them in warm soapy water. Rinse under running water, and dry.

IMPORTANT: To ensure continued and effective performance, do not put the Jar, Filler Cap or Tamper in the dishwasher.

Motor Base:

Wash the outside surface with a damp soft cloth or sponge, which has been rinsed in a mild solution of liquid detergent and warm water. Do not place the Motor Base in water.

The centring pad can be removed for more thorough cleaning.

Thoroughly clean the switches so they can work freely. They may become sticky from use. Moisten a cotton swab with a household cleaner and clean the grooves around the switches. Immediately dry all surfaces.

CHERENZ GLOBAL MFG. INC., DISTRIBUTOR OF TOUGH MAMA HOME AND KITCHEN APPLIANCES, SHALL NOT BE RESPONSIBLE FOR ANY FIRE, SCALDING OR INJURY FROM MISUSE OR NEGLIGENCE FROM THE USE THEREOF.



TOUGH MAMA[®]

